

DISASSEMBLY & ASSEMBLY GLOBE VALVE
WITH FIXED BACKSEAT $\leq 2\frac{1}{2}$ "

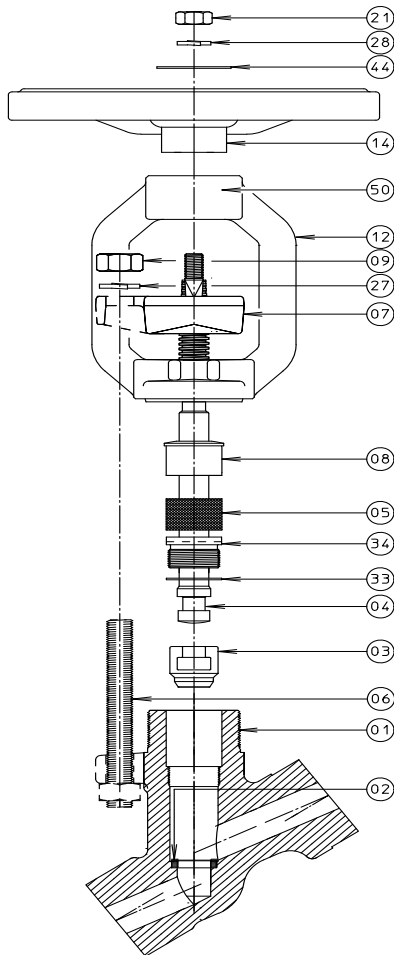

1. Caution, before any attempt is made to disassemble, verify that the valve is sufficiently cooled down, depressurised, isolated from system pressure and secured against accidental pressurisation
2. Unscrew the nuts (09) from the gland bolts (06) and remove them from the gland flange (07).
3. Remove the handwheel nut (21) which secures the spring washer (28) and nameplate (44).
4. Loosen the yoke (12) by rotating it counter clockwise.
5. Unscrew the yoke (12) from the valve body (01) while rotating the handwheel (14) clockwise to unscrew the stem (04) from the yoke sleeve (50) until the handwheel (14) disengages from the stem (04).
6. Remove the yoke (12) together with the gland flange (07) and gland (08) from the valve body (01).
7. Remove the packing (05) from the valve body (01).
8. Install the backseat removal tool on to the valve body (01) by screwing the adaptor to the threaded part of the valve body (01).
9. Loosen the backseat (34) by rotating the backseat removal tool in counter clockwise direction.
10. Unscrew the backseat removal tool from the valve body (01) and remove it together with the backseat (34), gasket (33), stem (04) and disc (03).

INSPECTION PRIOR TO RE-ASSEMBLY

1. Thoroughly clean all parts with solvent and a clean cloth.
2. Examine the following parts for signs of damage, i.e. pitting, erosion or scratches:
 - A. SEAT (02) - Sealing surface
 - B. STEM (04) - Packing area
 - C. DISC (03) - Sealing surface
 - D. BACKSEAT (04 & 34) - Sealing surface
3. Lubricate all threaded parts with high temperature grease, i.e. Molykote HSC.
4. Insert the stem (04) in the designated slot located in the disc (03).
5. Insert the stem/disc assembly into the valve body (01).
6. Insert the gasket (33) and the backseat (34) into the valve body (01).
7. Install the backseat removal tool on to the valve body (01) by screwing the adaptor to the threaded part of the valve body (01).
8. Screw the backseat (34) into the valve body (01) and fasten it by rotating it clockwise.
9. Insert the packing (05) with markings facing down into the valve body (01).
10. Place the gland (08) over the stem (04).
11. Put the yoke (12) together with the gland flange (07) over the stem (04) and fixate the gland flange (07) with the gland bolts (06).
12. Fixate the handwheel (14) and nameplate (44) to the stem (04) with the handwheel nut (21) and washer (28).
13. Tighten the gland nuts (09) to compress the packing (05).
14. Loosen the gland nuts (09) slightly. Now carefully retighten the gland nuts (09) again.
15. Pressurise the system and check the packing (05) for leakage.
16. In case of leakage tighten the gland nuts (09) carefully until the leakage stops.
17. The valve is now ready for use.



**IN CASE SEVERE DAMAGE IS OBSERVED,
USE REPLACEMENT PARTS INSTEAD!**